

MARBLEIZING

MADE EASY WITH

MUNGYO GALLERY SOFT PASTELS

Grades 6-8



OBJECTIVES

Students will...

- Be able to create beautiful marbled designs on a variety of papers, creating unique and colourful patterns.
- Incorporate visual patterns and colour blending with selective placement and control.
- Demonstrate how fluids can be utilized to enhance colour through a seemingly random process.

THIS MARBLEIZING TECHNIQUE IS EASY — RELAX AND HAVE FUN!

INSTRUCTIONS

- 1** Place enough cool tap water in the pan to cover the bottom, about ¼" to ½".
- 2** Select three contrasting sticks of Mungyo Gallery Soft Pastels. You can use any three colours, but a careful selection of colours that complement each other is best (like red, orange, and contrasting violet).
- 3** Hold a stick of pastel over the pan of water. Vigorously scrape the side of the pastel with your straight-edge scraper and let the pastel dust fall onto the water surface. Scrape so that the flakes of pastel are more like dust, rather than chunks of pastel. More pastel dust is better than a little. Repeat with the next two sticks of coloured pastel, letting one colour fall onto the previous colour.
- 4** Gently rock the pan by lifting one edge and dropping it back. This will cause the water to swirl the pastel floating on the surface. Watch the pastel dust form patterns on the water. If you want, you can use a pencil or stick to gently swirl the water.
- 5** Take a sheet of paper, cut it to the desired size, and position it over the pan. Select an area where the pastel has swirled in an interesting way. If you don't like the current pattern in the pastel, stop and add more pastel dust or lift the pan edge again to create a more attractive pattern. Once you are satisfied with the pattern on the water, place the paper on the water surface by laying one corner on the water first, followed by the rest of the paper.
- 6** This next step is very important. Remove the paper as soon as it contacts the water. Do not let it linger. The sooner it is removed, the better the pastel impression. Remove the paper with your fingers or tongs. **NOTE:** Wear rubber gloves to keep your fingers from being stained by the pastel.
Place your marbled paper onto a paper towel and let dry. Drying is usually very quick because the paper was not contacting the water long enough to saturate it.
- 7** Repeat steps 5 and 6 for a lighter, softer version of the pattern. Each successive marbleizing print will be lighter, as more pastel is removed from the water surface.

Start over with clean water and pastel.

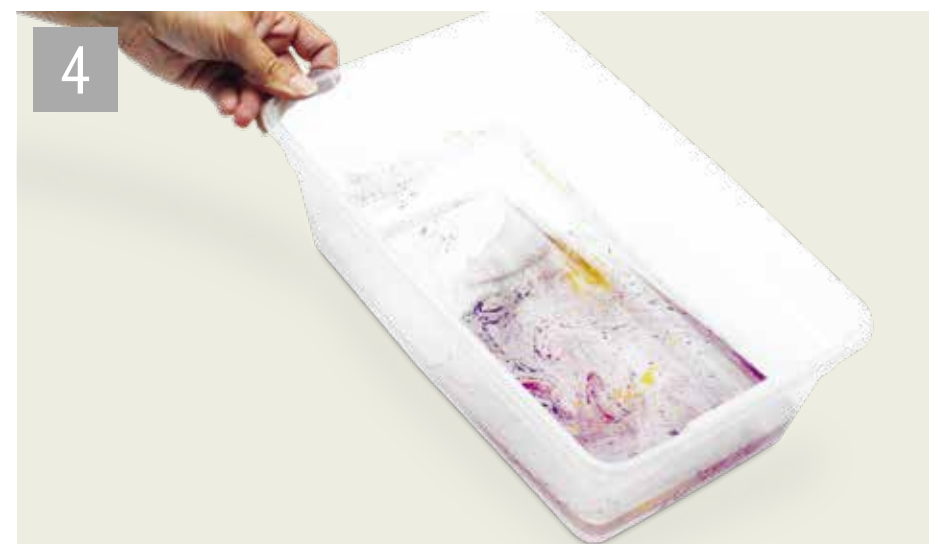
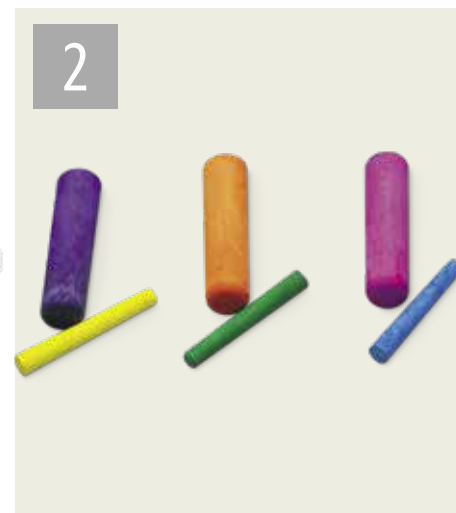

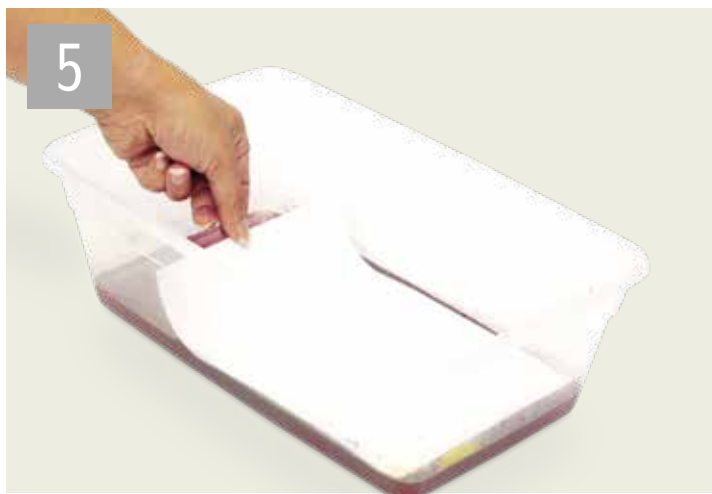

5



6



7

FOLLOW-UP IDEAS

- Depending on the marbled sheet size, several things can be done. If the finished sheet size is 8½" x 11", you may be able to print on it with an ink jet computer printer, or run it through a copy machine to print a message on it.
- Cut your paper to size and glue it to a book jacket or greeting card. Personalize it by drawing on the marbled print with coloured pencils or markers.
- Spray the marbled paper with a fixative (like Krylon Workable Fixatif) to enhance the colours and preserve it.
- Marbleize the other side in a different colour. Fold the paper in half to make a greeting card and write a message on the front or back.
- Create a resist. Use a white crayon to draw on the paper before you marbleize. Where you mark the paper with the crayon, the pastel will not stick. EXAMPLE: Draw your design with the crayon and dip the paper. The marbleizing will stain the paper, not your drawing. Experiment and have fun until you are satisfied with your technique.



MATERIALS LIST

- Nasco White All Media Drawing Paper, 9" x 12", pkg. of 500 sheets — [9728257](#)
- Small pan (should be larger than the paper — pastels will stain the pan, so use an old pan or dedicate one for marbleizing)
- Mungyo Gallery Soft Pastels
 - Assorted Colours, Set of 12 - [240146](#)
 - Assorted Colours, Set of 24 - [240150](#)
 - Assorted Colours, Set of 36 - [240151](#)
 - Assorted Colours, Set of 48 - [240152](#)
- Krylon Workable Fixatif — [0900597](#)
- Scraper (any stiff or straight edge can be used)
- Paper towels
- Water

SPECTRUM
EDUCATIONAL SUPPLIES

150 Pony Drive Newmarket, ON L3Y 7B6
Telephone: 1-800-668-0600
Online: spectrumed.ca